



FIVE STAR
General S.L.



STONE DEPARTMENT





FIVE STAR General ,Stone Department , a combination of 10 factories and 7 quarries have been activated in stone sector since 2018.We are an enterprise in all kind of manufacturers and suppliers of stones,in Spain and the other Countries ; as you know there are many rich stone mines , by high capacity and good quality that would stone industrial especially Onyx, Marble, Travertine and Granite .

We're be able to meet your interests and the other customer's requirements. Our products have been sold in many countries such as: EU , CIS , KSA , GCC, SOUTH AFRICA, UK and etc. At this present time, with having different quarries of Travertine and Marble , We're proud of being the leading manufacturer and exporter of Asian unique stones. We offer our own ranges of Marble, Travertine , Onyx, Granite and stone products . Our group specializes in finding precious materials and supplying top notch products at the best prices for project works & large scale installations. All products are checked and tested before being placed on the market.Our aim is to serve best quality of natural stones to all over the world.We produce our stones in forms of slab , block cut to size and calibrated tiles . We produce regular finishing: polished, honed, and . brushed. You can find your desire in .our Website .

STONE COLLECTION

- Travertine
- Marble
- Onyx
- Travonyx
- Granite



Travertine



T 01



Name: **Abbas Abad**

Color: **White Travertine**

Surface Finishing: **Polished**

Supply Ability: **10000M2/ Month**

Min. Order: **500 (Square Meters)**

Packaging Detail: **Wooden/Iron Packing (standard packing)**

Shipment Terms: **FOB, CFR, CIF**

Payment Terms: **T/T, L/C**

Description:

Abbas Abad is a unique stone of quarries in White Travertine which is presented in slab and tile.

Finishes: Polished, Honed, Leathered and Tumbled



Grade	Size(cm)	Surface	Stone Form
A	80*80*2 TO 270*170*2	Polished	Slab
A	30*60*2	Polished	Tile
A	40*80*2	Polished	Tile

T 02



Name: **AZAR SHAHR**

Color: **Red**

Surface Finishing: **Polished**

Supply Ability: **50000M2/ Month**

Min. Order: **500 (Square Meters)**

Packaging Detail: **Wooden/Iron Packing
(standard packing)**

Shipment Terms: **FOB, CFR, CIF**

Payment Terms: **T/T, L/C**

Description:

Finishes: **Polished, Honed, Leathered and Tumbled**



Grade	Size(cm)	Surface	Stone Form
A	100*100*2 TO 270*160*2	Polished	Slab
A	30*60*2	Polished	Tile
A	40*80*2	Polished	Tile

T 03



Name: **AZAR SHAHR**

Color: **Yellow(Lemon)**

Surface Finishing: **Polished**

Supply Ability: **50000M2/ Month**

Min. Order: **500 (Square Meters)**

Packaging Detail: **Wooden/Iron Packing (standard packing)**

Shipment Terms: **FOB, CFR, CIF**

Payment Terms: **T/T, L/C**

Description:

Finishes: **Polished, Honed, Leathered and Tumbled**



Grade	Size(cm)	Surface	Stone Form
A	100*100*2 TO 270*160*2	Polished	Slab
A	30*60*2	Polished	Tile
A	40*80*2	Polished	Tile



T 04



Name: **TAKAB**
Color: **Grey**
Surface Finishing: **Polished**
Supply Ability: **50000M2/ Month**
Min. Order: **500 (Square Meters)**
Packaging Detail: **Wooden/Iron Packing (standard packing)**
Shipment Terms: **FOB, CFR, CIF**
Payment Terms: **T/T, L/C**
Description:
Finishes: **Polished, Honed, Leathered and Tumbled**

Grade	Size(cm)	Surface	Stone Form
A	100*100*2 TO 270*160*2	Polished	Slab
A	30*60*2	Polished	Tile
A	40*80*2	Polished	Tile



T 05



Name: **Chocolate Brown**

Color: **Brown**

Surface Finishing: **Polished**

Supply Ability: **50000M2/ Month**

Min. Order: **500 (Square Meters)**

Packaging Detail: **Wooden/Iron Packing
(standard packing)**

Shipment Terms: **FOB, CFR, CIF**

Payment Terms: **T/T, L/C**

Description:

Finishes: **Polished, Honed, Leathered and Tumbled**



Grade	Size(cm)	Surface	Stone Form
A	100*100*2 TO 270*160*2	Polished	Slab
A	30*60*2	Polished	Tile
A	40*80*2	Polished	Tile

T 06



Name: **Abbas Abad**

Color: **Super White Travertine**

Surface Finishing: **Polished**

Supply Ability: **10000M2/ Month**

Min. Order: **500 (Square Meters)**

Packaging Detail: **Wooden/Iron Packing (standard packing)**

Shipment Terms: **FOB, CFR, CIF**

Payment Terms: **T/T, L/C**

Description:

Finishes: **Polished, Honed, Leathered and Tumbled**

Grade	Size(cm)	Surface	Stone Form
A	80*80*2 TO 270*170*2	Polished	Slab
A	30*60*2	Polished	Tile
A	40*80*2	Polished	Tile



T 07



Name: **Walnut Travertine**

Color: **Brown**

Surface Finishing: **Polished**

Supply Ability: **20000M2/ Month**

Min. Order: **500 (Square Meters)**

Packaging Detail: **Wooden/Iron Packing (standard packing)**

Shipment Terms: **FOB, CFR, CIF**

Payment Terms: **T/T, L/C**

Description:

Walnut Travertine is a unique stone of quarries of brown Travertine which is presented in slab and tile.

Finishes: Polished, Honed, Leathered and Tumbled

Grade	Size(cm)	Surface	Stone Form
A	80*80*2 TO 240*170*2	Polished	Slab
A	30*60*2	Polished	Tile
A	40*80*2	Polished	Tile



Marble





M 01



Name: **Petro Gray**

Color: **Black**

Surface Finishing: **Polished**

Supply Ability: **50000M2/ Month**

Min. Order: **500 (Square Meters)**

Packaging Detail: **Wooden/Iron Packing
(standard packing)**

Shipment Terms: **FOB, CFR, CIF**

Payment Terms: **T/T, L/C**

Description:

Finishes: **Polished, Leathered and Tumbled**

Grade	Size(cm)	Surface	Stone Form
A	80*80*2 TO 270*180*2	Polished	Slab
A	30*60*2	Polished	Tile
A	40*80*2	Polished	Tile



M 02



Name: **Withe White**

Color: **Black**

Surface Finishing: **Polished**

Supply Ability: **40000M2/ Month**

Min. Order: **500 (Square Meters)**

Packaging Detail: **Wooden/Iron Packing
(standard packing)**

Shipment Terms: **FOB, CFR, CIF**

Payment Terms: **T/T, L/C**

Description:

Finishes: Polished, Leathered and Tumbled



Grade	Size(cm)	Surface	Stone Form
A	80*80*2 TO 270*170*2	Polished	Slab
A	30*60*2	Polished	Tile
A	40*80*2	Polished	Tile

M 03



Name: **Green-Gray**

Color: **Gray**

Surface Finishing: **Polished**

Supply Ability: **5000M2/ Month**

Min. Order: **500 (Square Meters)**

Packaging Detail: **Wooden/Iron Packing (standard packing)**

Shipment Terms: **FOB, CFR, CIF**

Payment Terms: **T/T, L/C**

Description:

Finishes: **Polished, Leathered and Tumbled**

Grade	Size(cm)	Surface	Stone Form
A	80*80*2 TO 240*160*2	Polished	Slab
A	30*60*2	Polished	Tile
A	40*80*2	Polished	Tile



M 04

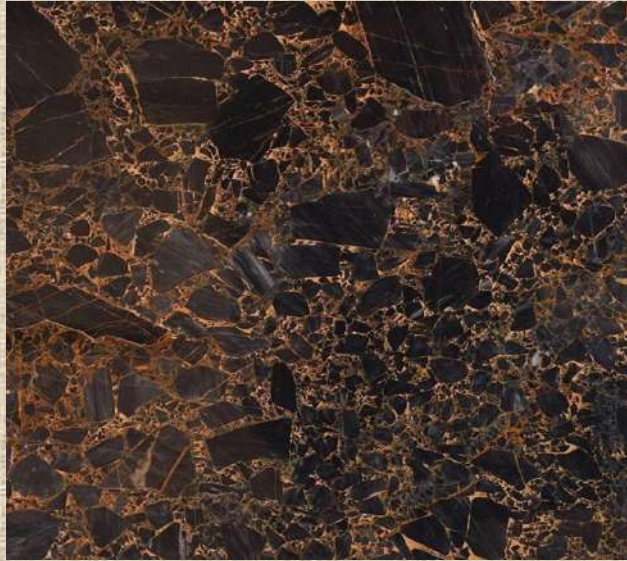

Name: **Marshal**

Color: **Black**

Surface Finishing: **Polished**

Supply Ability: **10000M2/ Month**

Min. Order: **500 (Square Meters)**

Packaging Detail: **Wooden/Iron Packing
(standard packing)**

Shipment Terms: **FOB, CFR, CIF**

Payment Terms: **T/T, L/C**

Description:

Finishes: Polished, Leathered and Tumbled



Grade	Size(cm)	Surface	Stone Form
A	80*80*2 TO 270*180*2	Polished	Slab
A	30*60*2	Polished	Tile
A	40*80*2	Polished	Tile

M 05



Name: **Dehbid**

Color: **Beige**

Surface Finishing: **Polished**

Supply Ability: **40000M2/ Month**

Min. Order: **500 (Square Meters)**

Packaging Detail: **Wooden/Iron Packing (standard packing)**

Shipment Terms: **FOB, CFR, CIF**

Payment Terms: **T/T, L/C**

Description:

Finishes: **Polished, Leathered and Tumbled**



Grade	Size(cm)	Surface	Stone Form
A	80*80*2 TO 270*180*2	Polished	Slab
A	30*60*2	Polished	Tile
A	40*80*2	Polished	Tile

M 06



Name: **Shayan**

Color: **Cream**

Surface Finishing: **Polished**

Supply Ability: **20000M2/ Month**

Min. Order: **500 (Square Meters)**

Packaging Detail: **Wooden/Iron Packing (standard packing)**

Shipment Terms: **FOB, CFR, CIF**

Payment Terms: **T/T, L/C**

Description:

Finishes: **Polished, Leathered and Tumbled**



Grade	Size(cm)	Surface	Stone Form
A	80*80*2 TO 270*180*2	Polished	Slab
A	30*60*2	Polished	Tile
A	40*80*2	Polished	Tile

M 07



Name: **Peacocks**

Color: **Cream**

Surface Finishing: **Polished**

Supply Ability: **8000M2/ Month**

Min. Order: **500 (Square Meters)**

Packaging Detail: **Wooden/Iron Packing
(standard packing)**

Shipment Terms: **FOB, CFR, CIF**

Payment Terms: **T/T, L/C**

Description:

Finishes: **Polished, Leathered and Tumbled**



Grade	Size(cm)	Surface	Stone Form
A	80*80*2 TO 270*180*2	Polished	Slab
A	30*60*2	Polished	Tile
A	40*80*2	Polished	Tile



M 08



Name: **Persian Silk**

Color: **Gray**

Material Origin: **Iran**

Surface Finishing: **Polished**

Supply Ability: **7000M2/ Month**

Min. Order: **500 (Square Meters)**

Packaging Detail: **Wooden/Iron Packing (standard packing)**

Shipment Terms: **FOB, CFR, CIF**

Payment Terms: **T/T, L/C**

Description:

Finishes: **Polished, Leathered and Tumbled**

Grade	Size(cm)	Surface	Stone Form
A	80*80*2 TO 270*180*2	Polished	Slab
A	30*60*2	Polished	Tile
A	40*80*2	Polished	Tile



M 09



Name: **Oak**

Color: **Brown**

Surface Finishing: **Polished**

Supply Ability: **10000M2/ Month**

Min. Order: **500 (Square Meters)**

Packaging Detail: **Wooden/Iron Packing (standard packing)**

Shipment Terms: **FOB, CFR, CIF**

Payment Terms: **T/T, L/C**

Description:

Finishes: Polished, Leathered and Tumbled

Grade	Size(cm)	Surface	Stone Form
A	80*80*2 TO 270*180*2	Polished	Slab
A	30*60*2	Polished	Tile
A	40*80*2	Polished	Tile



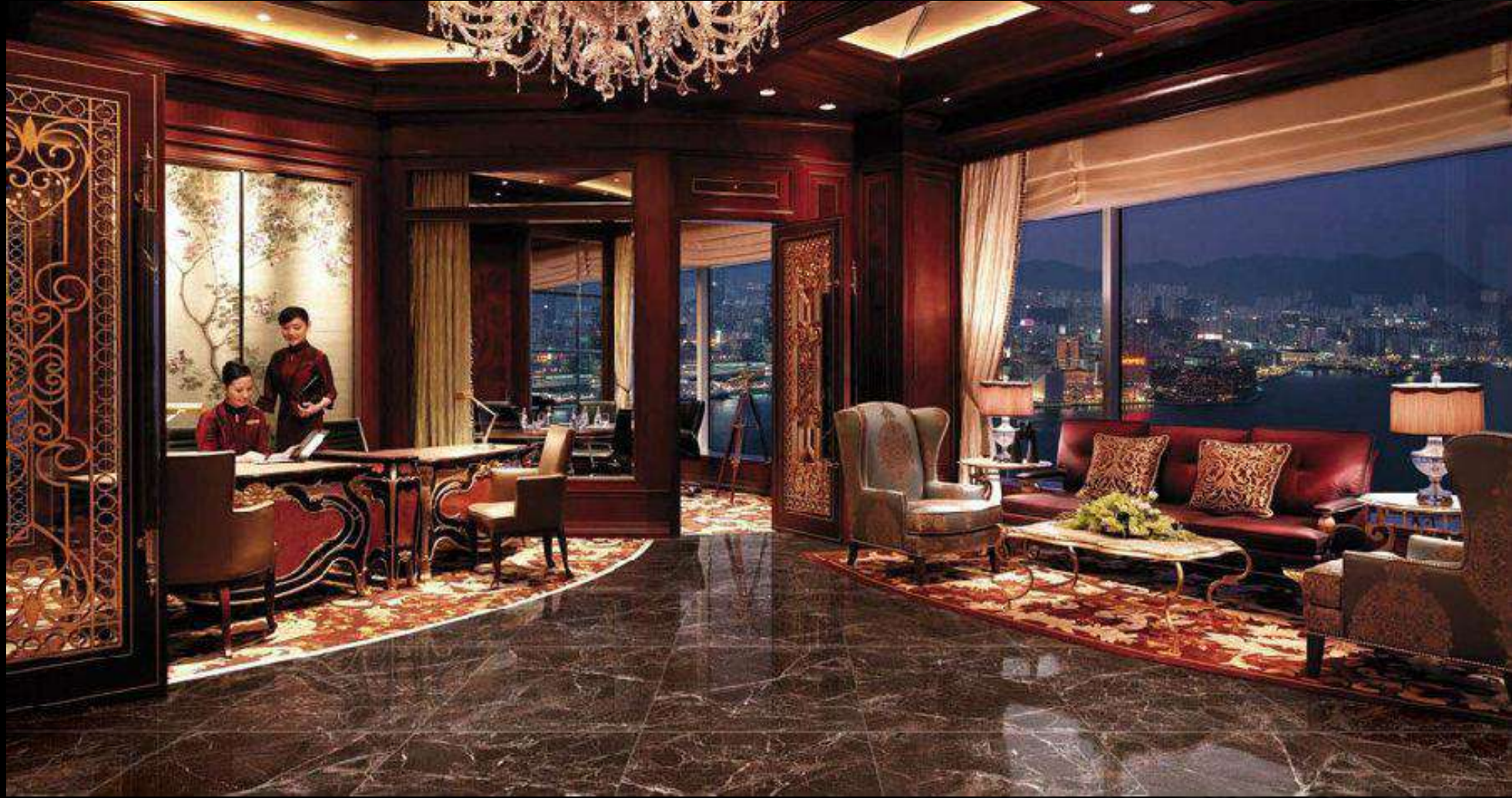

M 10



Name: **3D Black**

Color: **Black**

Surface Finishing: **Polished**

Supply Ability: **20000M2/ Month**

Min. Order: **500 (Square Meters)**

Packaging Detail: **Wooden/Iron Packing
(standard packing)**

Shipment Terms: **FOB, CFR, CIF**

Payment Terms: **T/T, L/C**

Description:

Finishes: Polished, Leathered and Tumbled

Grade	Size(cm)	Surface	Stone Form
A	80*80*2 TO 270*180*2	Polished	Slab
A	30*60*2	Polished	Tile
A	40*80*2	Polished	Tile



M 11



Name: **Golden Black**

Color: **Black**

Surface Finishing: **Polished**

Supply Ability: **20000M2/ Month**

Min. Order: **500 (Square Meters)**

Packaging Detail: **Wooden/Iron Packing (standard packing)**

Shipment Terms: **FOB, CFR, CIF**

Payment Terms: **T/T, L/C**

Description:

Finishes: Polished, Leathered and Tumbled

Grade	Size(cm)	Surface	Stone Form
A	80*80*2 TO 270*180*2	Polished	Slab
A	30*60*2	Polished	Tile
A	40*80*2	Polished	Tile



M 12



Name: **Cloudy**

Color: **Gray**

Surface Finishing: **Polished**

Supply Ability: **10000M2/ Month**

Min. Order: **500 (Square Meters)**

Packaging Detail: **Wooden/Iron Packing
(standard packing)**

Shipment Terms: **FOB, CFR, CIF**

Payment Terms: **T/T, L/C**

Description:

Finishes: Polished, Leathered and Tumbled

Grade	Size(cm)	Surface	Stone Form
A	80*80*2 TO 270*180*2	Polished	Slab
A	30*60*2	Polished	Tile
A	40*80*2	Polished	Tile



M 13



Name: **AZNA**

Color: **White**

Surface Finishing: **Polished**

Supply Ability: **20000M2/ Month**

Min. Order: **500 (Square Meters)**

Packaging Detail: **Wooden/Iron Packing (standard packing)**

Shipment Terms: **FOB, CFR, CIF**

Payment Terms: **T/T, L/C**

Description:

Finishes: **Polished, Leathered and Tumbled**

Grade	Size(cm)	Surface	Stone Form
A	80*80*2 TO 270*180*2	Polished	Slab
A	30*60*2	Polished	Tile
A	40*80*2	Polished	Tile



M 14



Name: **President**

Color: **Black-Yellow**

Surface Finishing: **Polished**

Supply Ability: **7000M2/ Month**

Min. Order: **500 (Square Meters)**

Packaging Detail: **Wooden/Iron Packing (standard packing)**

Shipment Terms: **FOB, CFR, CIF**

Payment Terms: **T/T, L/C**

Description:

Finishes: **Polished, Leathered and Tumbled**



Grade	Size(cm)	Surface	Stone Form
A	80*80*2 TO 270*180*2	Polished	Slab
A	30*60*2	Polished	Tile
A	40*80*2	Polished	Tile

M 15



Name: **Yashmin**

Color: **Green**

Surface Finishing: **Polished**

Supply Ability: **4000M2/ Month**

Min. Order: **500 (Square Meters)**

Packaging Detail: **Wooden/Iron Packing (standard packing)**

Shipment Terms: **FOB, CFR, CIF**

Payment Terms: **T/T, L/C**

Description:

Finishes: Polished, Leathered and Tumbled



Grade	Size(cm)	Surface	Stone Form
A	80*80*2 TO 270*180*2	Polished	Slab
A	30*60*2	Polished	Tile
A	40*80*2	Polished	Tile

M 16



Name: **Golden Rose**

Color: **Red**

Surface Finishing: **Polished**

Supply Ability: **40000M2/ Month**

Min. Order: **500 (Square Meters)**

Packaging Detail: **Wooden/Iron Packing
(standard packing)**

Shipment Terms: **FOB, CFR, CIF**

Payment Terms: **T/T, L/C**

Description:

Finishes: **Polished, Leathered and Tumbled**



Grade	Size(cm)	Surface	Stone Form
A	80*80*2 TO 270*180*2	Polished	Slab
A	30*60*2	Polished	Tile
A	40*80*2	Polished	Tile



O
N
Y
X

SPECIAL STONE

OX 01



Name: **Skye**
Color: **Blue**
Surface Finishing: **Polished**
Supply Ability: **1000M2/ Month**
Min. Order: **100 (Square Meters)**
Packaging Detail: **Wooden/Iron Packing (standard packing)**
Shipment Terms: **FOB, CFR, CIF**
Payment Terms: **T/T, L/C**
Description:

Finishes: Polished, Leathered and Tumbled

Grade	Size(cm)	Surface	Stone Form
A	80*80*2 TO 220*160*2	Polished	Slab
A	30*60*2	Polished	Tile
A	40*80*2	Polished	Tile



OX 02



Name: **Harami**

Color: **Green**

Surface Finishing: **Polished**

Supply Ability: **500M2/ Month**

Min. Order: **100 (Square Meters)**

Packaging Detail: **Wooden/Iron Packing (standard packing)**

Shipment Terms: **FOB, CFR, CIF**

Payment Terms: **T/T, L/C**

Description:

Finishes: **Polished, Leathered and Tumbled**



Grade	Size(cm)	Surface	Stone Form
A	80*80*2 TO 240*170*2	Polished	Slab
A	30*60*2	Polished	Tile
A	40*80*2	Polished	Tile



OX 03

Name: **Pink Light**

Color: **Pink**

Surface Finishing: **Polished**

Supply Ability: **1000M2/ Month**

Min. Order: **100 (Square Meters)**

Packaging Detail: **Wooden/Iron Packing
(standard packing)**

Shipment Terms: **FOB, CFR, CIF**

Payment Terms: **T/T, L/C**

Description:

Finishes: **Polished, Leathered and Tumbled**



Grade	Size(cm)	Surface	Stone Form
A	80*80*2 TO 250*170*2	Polished	Slab
A	30*60*2	Polished	Tile
A	40*80*2	Polished	Tile



OX 04

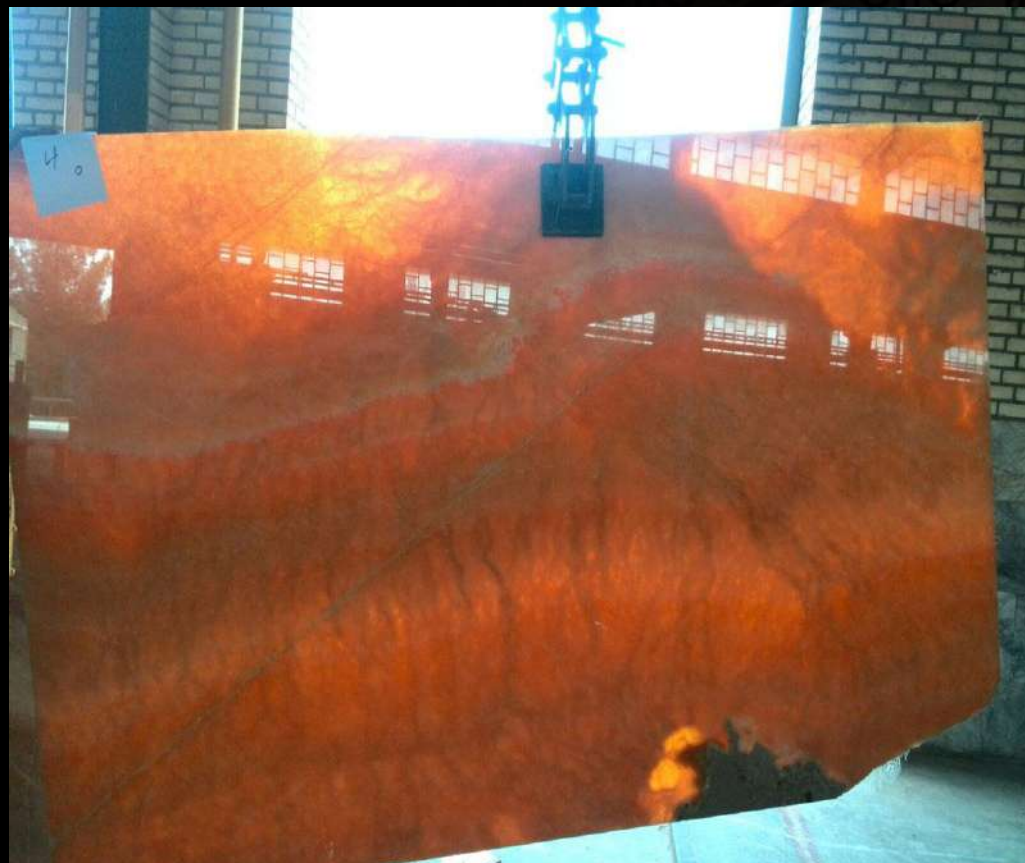

Name: **Sunset**

Color: **Honey**

Surface Finishing: **Polished**

Supply Ability: **2000M2/ Month**

Min. Order: **300 (Square Meters)**

Packaging Detail: **Wooden/Iron Packing (standard packing)**

Shipment Terms: **FOB, CFR, CIF**

Payment Terms: **T/T, L/C**

Description:

Finishes: **Polished, Leathered and Tumbled**



Grade	Size(cm)	Surface	Stone Form
A	80*80*2 TO 270*180*2	Polished	Slab
A	30*60*2	Polished	Tile
A	40*80*2	Polished	Tile

OX 05



Name: **Pearl Face**
Color: **White**
Surface Finishing: **Polished**
Supply Ability: **1000M2/ Month**
Min. Order: **200 (Square Meters)**
Packaging Detail: **Wooden/Iron Packing (standard packing)**
Shipment Terms: **FOB, CFR, CIF**
Payment Terms: **T/T, L/C**
Description:

Finishes: Polished, Leathered and Tumbled

Grade	Size(cm)	Surface	Stone Form
A	80*80*2 TO 270*180*2	Polished	Slab
A	30*60*2	Polished	Tile
A	40*80*2	Polished	Tile



OX 06



Name: **Green Mountain**
Color: **Light Green**
Surface Finishing: **Polished**
Supply Ability: **1000M2/ Month**
Min. Order: **300 (Square Meters)**
Packaging Detail: **Wooden/Iron Packing (standard packing)**
Shipment Terms: **FOB, CFR, CIF**
Payment Terms: **T/T, L/C**
Description:

Finishes: Polished, Leathered and Tumbled



Grade	Size(cm)	Surface	Stone Form
A	80*80*2 TO 270*180*2	Polished	Slab
A	30*60*2	Polished	Tile
A	40*80*2	Polished	Tile

Travonyx



TX 01



Name: **Sun Cloudy**
Color: **Golden-Grey**
Surface Finishing: **Polished**
Supply Ability: **7000M2/ Month**
Min. Order: **500 (Square Meters)**
Packaging Detail: **Wooden/Iron Packing (standard packing)**
Shipment Terms: **FOB, CFR, CIF**
Payment Terms: **T/T, L/C**
Description:

Finishes: Polished, Leathered and Tumbled



Grade	Size(cm)	Surface	Stone Form
A	80*80*2 TO 270*180*2	Polished	Slab
A	30*60*2	Polished	Tile
A	40*80*2	Polished	Tile

Granite



G 01

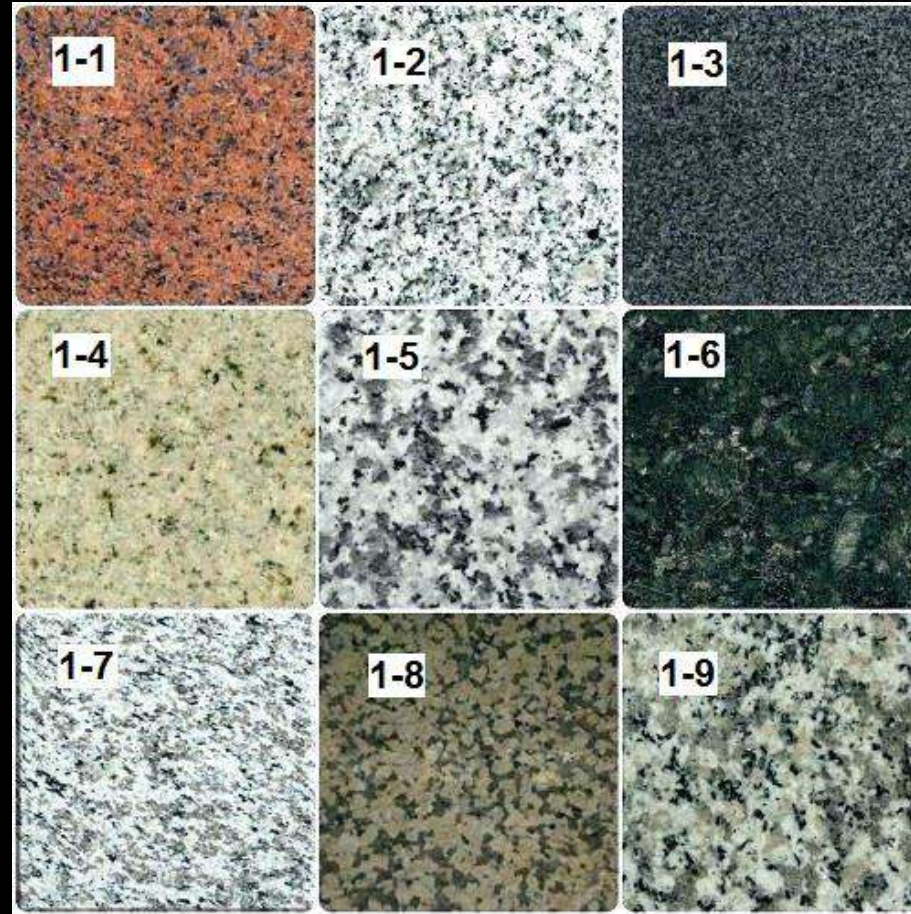

Name: **Bands of Griseous**
Surface Finishing: **Polished**
Supply Ability: **40000M2/ Month**
Min. Order: **500 (Square Meters)**
Packaging Detail: **Wooden/Iron Packing (standard packing)**
Shipment Terms: **FOB, CFR, CIF**
Payment Terms: **T/T, L/C**
Description:

Finishes: Polished, Leathered and Tumbled



Grade	Size(cm)	Surface	Stone Form
A	80*80*2 TO 270*180*2	Polished	Slab
A	30*60*2	Polished	Tile
A	40*80*2	Polished	Tile

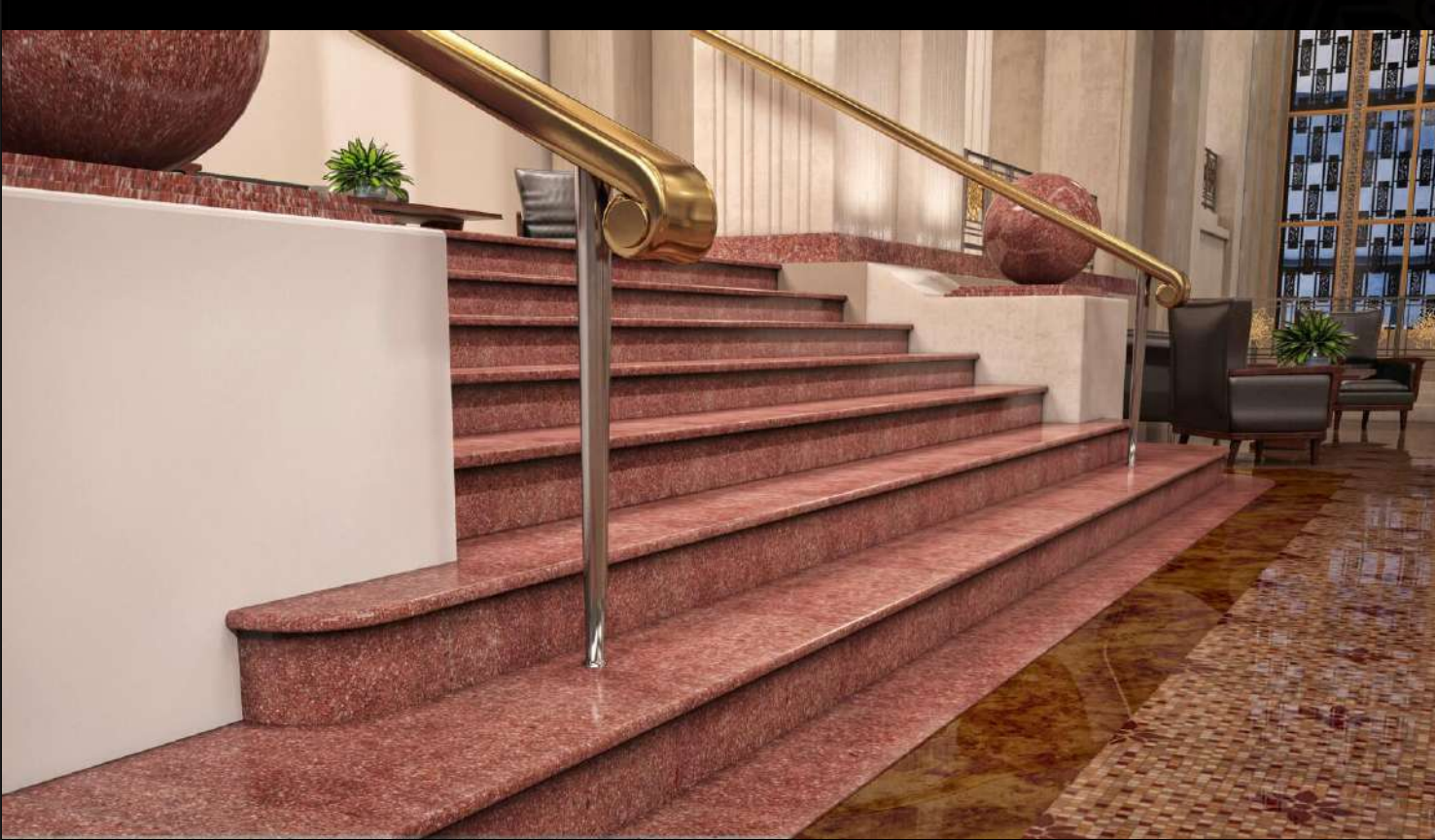

G 02



Name: **Slime Green**

Surface Finishing: **Polished**

Supply Ability: **10000M2/ Month**

Min. Order: **500 (Square Meters)**

Packaging Detail: **Wooden/Iron Packing (standard packing)**

Shipment Terms: **FOB, CFR, CIF**

Payment Terms: **T/T, L/C**

Description:

Finishes: **Polished, Leathered and Tumbled**



Grade	Size(cm)	Surface	Stone Form
A	80*80*2 TO 270*180*2	Polished	Slab
A	30*60*2	Polished	Tile
A	40*80*2	Polished	Tile

G 03

Name: **Cyan**

Surface Finishing: **Polished**

Supply Ability: **10000M2/ Month**

Min. Order: **500 (Square Meters)**

Packaging Detail: **Wooden/Iron**

Packing (standard packing)

Shipment Terms: **FOB, CFR, CIF**

Payment Terms: **T/T, L/C**

Description:

Finishes: **Polished, Leathered and Tumbled**



Grade	Size(cm)	Surface	Stone Form
A	80*80*2 TO 270*180*2	Polished	Slab
A	30*60*2	Polished	Tile
A	40*80*2	Polished	Tile

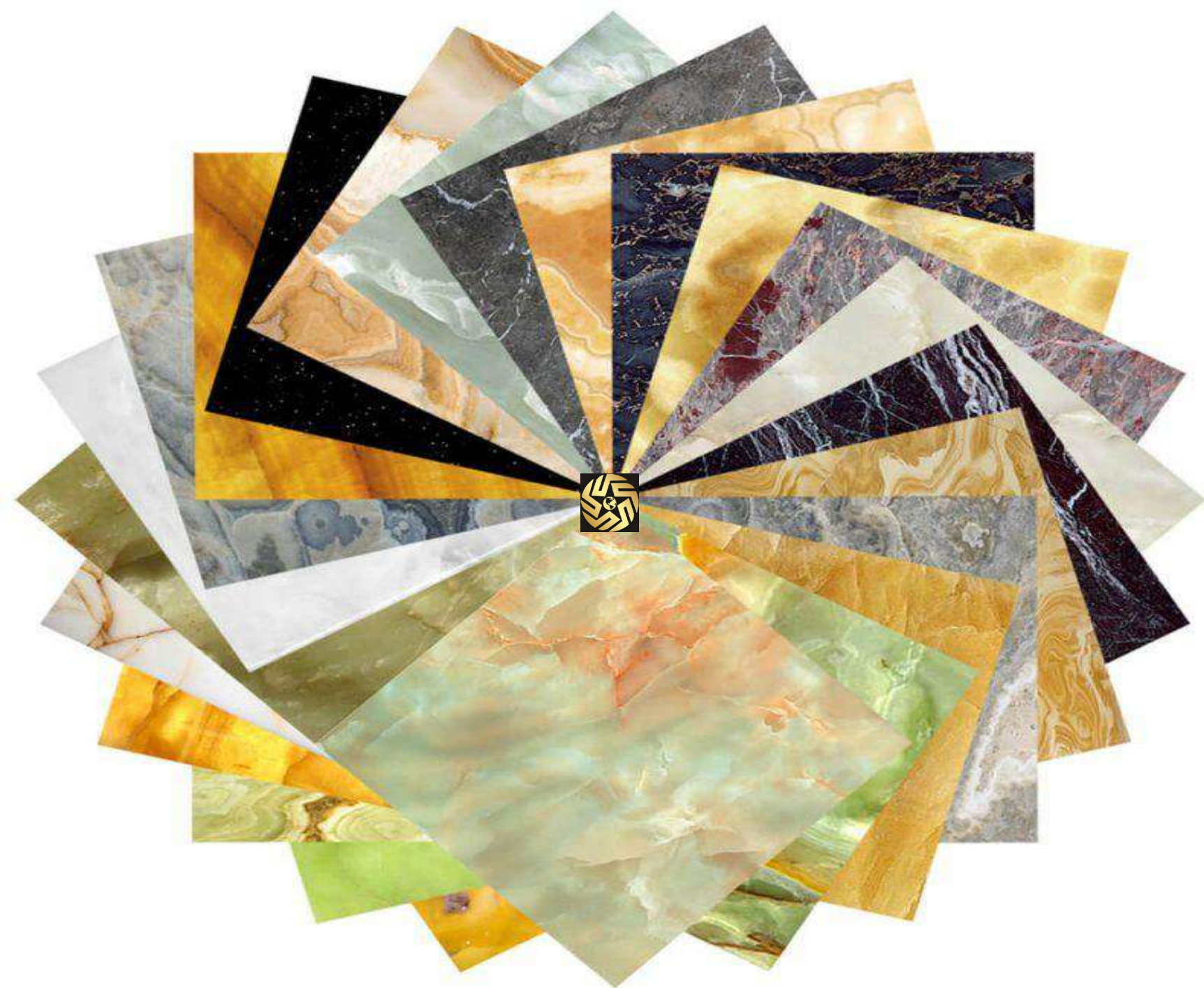

www.fivestargrupo.com